

INSTALLATION INSTRUCTIONS



TACOMA GEAR DRIVE T-CASE SHIFTER KIT

303073-1-KIT (2005-2015 TOYOTA TACOMA 4WD)

KIT CONTENTS



INSTALLATION INSTRUCTIONS



RECOMMENDED TOOLS

Ratchet & Socket Set

Paint Pen

Dremel Tool

Jack Stands or Vehicle Lift

Transmission Jack

Floor Jack

Drill & Drill Bit Set

2-3/8" Diameter Hole Saw

RTV Silicone (Ultra-Grey)

Snap Ring Pliers

CAUTION

1. Read all instructions completely and carefully before you begin. If anything is not clear, please call our tech support line at 1.877.4X4.TOYS or 559.252.4950 before proceeding.
2. Check to make sure the kit is complete and that no parts are missing (refer to the Kit Contents Section on the first page of these instructions). If anything is missing, please contact Trail-Gear at 1.877.4X4.TOYS or 559.252.4950.
3. Park vehicle on a clean, dry, flat, level surface and block the tires so the vehicle cannot roll in either direction.
4. This kit is for off-road use only. It is recommended that the installation steps below be performed by a competent mechanic. Buyers and users of this product hereby expressly assume all risks associated with the installation and use of this kit.
5. This installation is typical for most 2005-2015 Toyota Tacoma trucks. Some years or models may vary. If necessary, refer to the proper Factory Service Manual for the year and model of your Tacoma.
6. This instruction assumes you have already removed your stock chain-drive transfer case and have a gear-drive transfer case with a 4.0L adapter ready to install. It also assumes you have removed the center console assembly. If you need instructions on how to remove the stock chain-drive transfer case or any other stock component, refer to the proper Factory Service Manual for the year and model of your Tacoma.

SHIFTER MOUNT INSTALL

STEP 1

Place the vehicle securely on jack stands or a vehicle lift.

STEP 3

Insert the (2) Roll Pins into the Shifter Base. Install the Shifter Arm Weldment into the Shifter Base and secure using the Snap Ring provided. Make sure the Shifter Cone is underneath the Snap Ring.

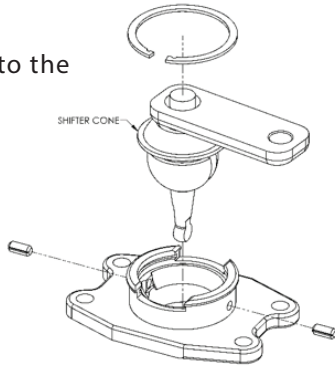

STEP 2

Carefully apply a coat of paint to the jog plate to prevent corrosion. Do not apply paint to the threads on the jog plate. Allow to dry completely before proceeding to the next step.

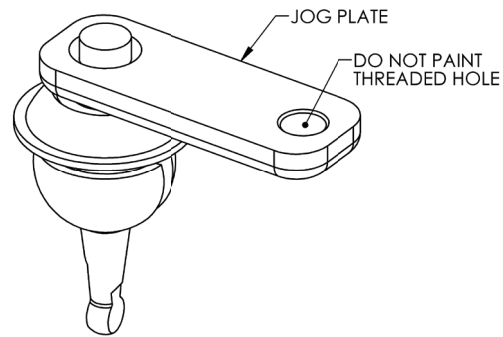

STEP 4

Apply RTV silicone to the shifter boss on the T-case.



STEP 5

Install the shifter on to the T-case using the (4) bolts that held the previous shifter on to the T-case.

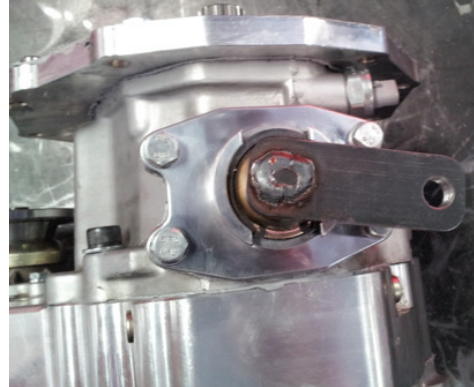

STEP 6

Mark and drill a 2-3/8" diameter clearance hole in the underbody for the T-case shifter. It is roughly 2-1/8" to the right of the plastic shifter housing and roughly 6" forward of the threaded hole for the parking brake cable mount, but you will need to verify the correct location before drilling. Carefully deburr the drilled hole. Make sure any wires and the parking brake cable are out of the way before drilling the hole. Paint the bare metal edges of the hole to prevent rust and corrosion.

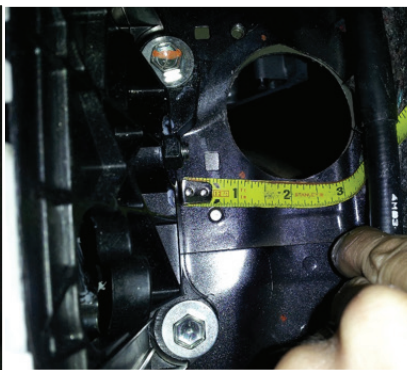

INSTALLATION INSTRUCTIONS



STEP 7

Install the T-Case onto the transmission and reconnect the drivelines to the transfer case.

STEP 8

Using the Shift Boot Retainer as a template, mark (3) mounting holes on the floorboard with a paint pen. Drill 1/8" maximum pilot holes in the marked locations.

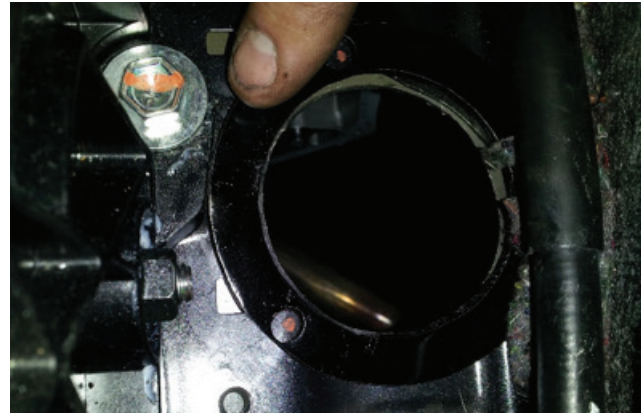

STEP 9

Using the supplied Jam Nut, install the Shift Lever onto the Jog Plate. Tighten the Jam Nut. Verify that the shifter will shift the T-case into all four positions.

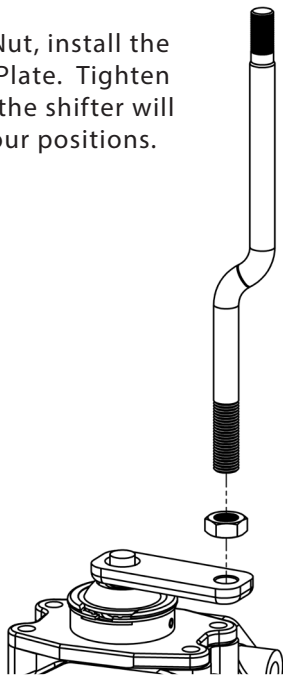

STEP 10

Slide the Shift Boot onto the shaft and push it down all the way to the floor. Secure the boot using the Shift Boot Retainer and the (3) screws provided.



STEP 11

Reinstall the entire center console assembly except for the shift console trim piece.

INSTALLATION INSTRUCTIONS



STEP 12

Using a Dremel tool, carefully cut a relief in the shift console as shown for the shifter. Reinstall the shift console. Again, make sure that the shifter will shift the T-case into all four positions.

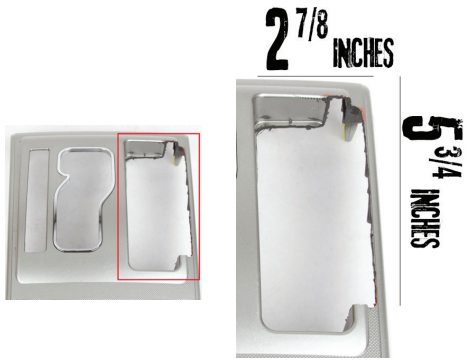

STEP 13

Install the supplied rubber Shift Knob onto the T-Case Shifter. Optional: If the amount of road noise from the Gear-Drive T-Case is objectionable, remove the Shift Knob & Shifter Trim Plate. Slit & trim the foam block supplied with this kit and install around the shift boot. Make sure that the shifter will still shift the T-case into all four shift positions. Reinstall the Shifter Trim Plate and the rubber Shift Knob.

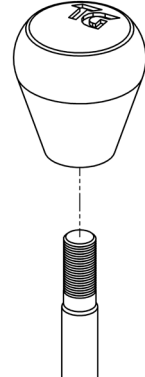

SERVICE PARTS

